



MAUNA LANI

AUBERGE RESORTS COLLECTION

HAWAII



THE LANI ESTATE

Invite the outdoors in at the Lani Estate, a seaside sanctuary situated mere minutes from Mauna Lani, Auberge Resorts Collection. Step onto the expansive lanai - equipped with outdoor entertainment spaces and a private infinity pool - as the peaceful rustling of palms blends seamlessly with the whisper of ocean waves to create a euphony of sounds that embody paradise. Entertain with loved ones in the spacious kitchen and living areas, where floor-to-ceiling doors provide an idyllic portal to saturated sunsets dotted with cotton candy clouds. Much like our little slice of paradise on the Kohala Coast, the Lani Estate beams warmly with aloha and ho'okipa (hospitality).



PRIVATE OCEAN VIEW LIVING

FIVE BEDROOMS | EIGHT BATHROOMS | 6,000 SQ. FT.

An enchanting oasis with prime views of a tranquil seascape, the Lani Estate embodies easy living.

- Five-minute drive from Mauna Lani
- Sleeps 12 - 15
- Full Designer Kitchen
- Private Media Room
- Infinity Pool





LIVING SPACES ARE AIRY, BRIGHT AND INVITING THROUGHOUT THE DAY AND INTO THE EVENING.





A THOUGHTFULLY LAID-OUT KITCHEN BLENDS WARM TONES AND TEXTURES WITH LUXURY APPLIANCES.



A HOME AWAY FROM HOME

Wide-open spaces seamlessly blend the indoors with the outdoors, welcoming breezy tradewinds, natural sunlight and the rejuvenating scent of ocean breeze.



LARGE AND INVITING, EVERY ESTATE BEDROOM IS THE PERFECT PLACE TO WAKE UP EACH MORNING.



UNPARALLELED SERVICE

Luxurious living is enhanced by a dedicated Guest Experience Team, exclusive access to Mauna Lani's facilities and experiences, and more.

- One complimentary roundtrip car transfer to and from Kona International Airport (KOA)
- Dedicated Guest Experience team available daily from check-in to check-out
- Complimentary golf cart use throughout stay (8 people max)
- Hand-selected assortment of wine presented upon arrival
- Complimentary round of tennis with on-property tennis pro
- \$200 daily activity resort credit available towards golf or spa
- \$400 daily breakfast credit at on-property restaurant HāLani
- Two complimentary one-day Cabana or Halau rentals
- Unpacking service available upon request. Steaming and dry cleaning available for an additional fee





MAUNA LANI
AREA MAP

WALKING TRAILS

- | | | | |
|--------------------------------------|----------------------------|------------------------------------|--------------------------------|
| 1 BEACH PARK & PETROGLYPH | 5 SHELTER CAVE | 8 MAUNA LANI SEA ADVENTURES & DOCK | 11 KEAWANUI CANOE LANDING |
| 2 SUBMARINE FRESHWATER SPRING | 6 "ALA LOA" OR KINGS TRAIL | 9 MĀKĀHĀ - SLUICE GATE | 12 ALA KAHAKAI SHORELINE TRAIL |
| 3 HISTORIC PARK & KALĀHUIPUA'A TRAIL | 7 SECRET POND | 10 EVA PARKER WOODS COTTAGE | 13 ILI'ILI STONE BEACH |
| 4 HAWAIIAN TOOLS MANUFACTURING | | | |

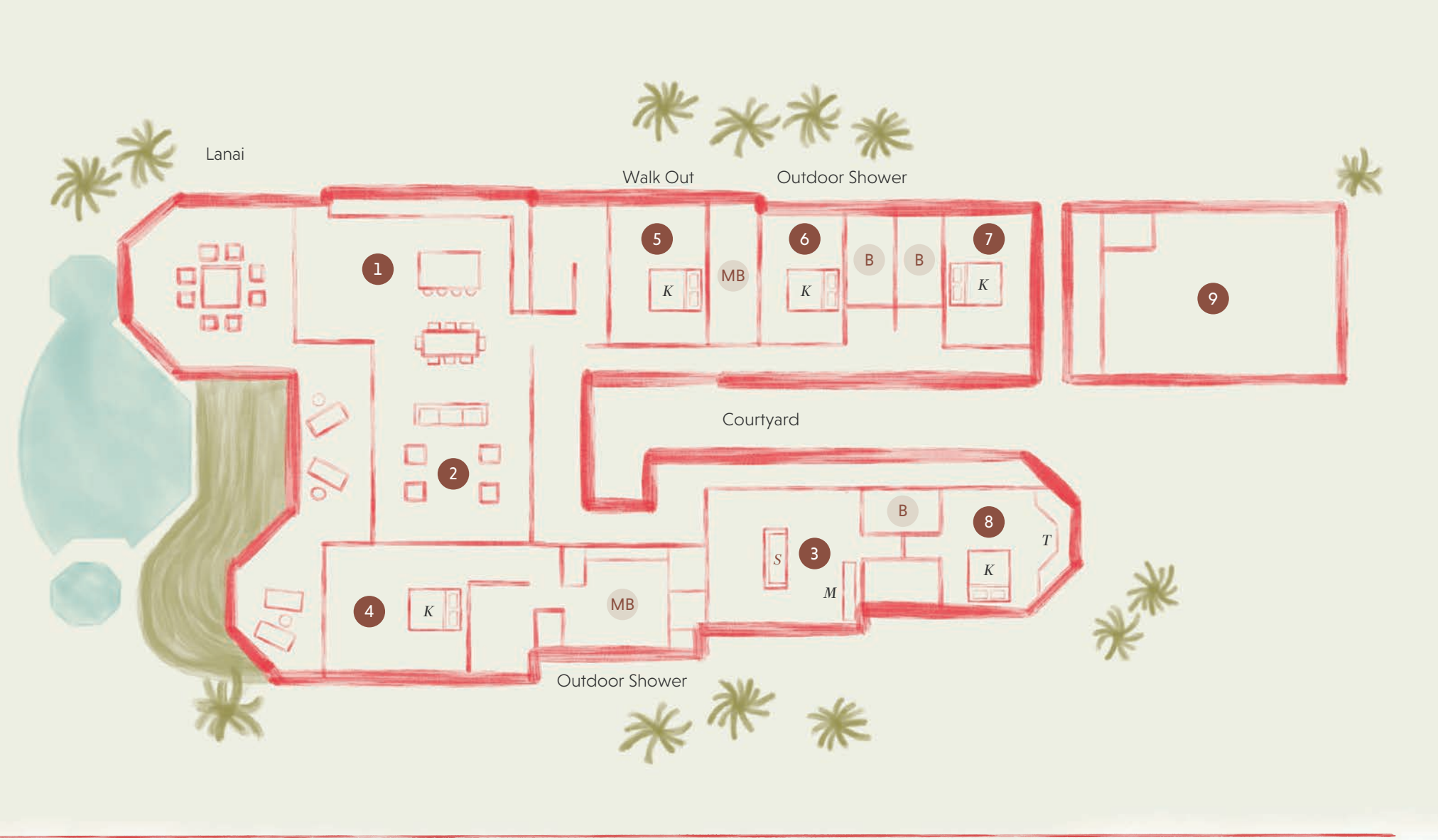

THE LANI ESTATE
6,000 SQ. FT.

- | | | | |
|--|--|---|--------------------------------|
| 1 KITCHEN | 5 MASTER BEDROOM 2
<i>King Bed + en Suite</i> | 8 BEDROOM 5
<i>King Bed + en Suite</i> | K KING BED |
| 2 LIVING ROOM | 6 BEDROOM 3
<i>King Bed + en Suite</i> | 9 GARAGE | S SOFA BED |
| 3 MEDIA ROOM
<i>Murphy Bed + Sofa Bed</i> | 7 BEDROOM 4
<i>King Bed + en Suite</i> | MB MASTER BATH | M MURPHY BED
<i>Full</i> |
| 4 MASTER BEDROOM 1
<i>King Bed + en Suite</i> | | B BATHROOM | T TRUNDLE BED
<i>Single</i> |



MAUNA LANI

AUBERGE RESORTS COLLECTION

HAWAII